

**TECHNICAL FILE:**

**PUSHBUTTON**



**1.- Technical specifications**

Rated voltage: 250 V ~

Rated current: 10 AX

Protection degree: IP20

Manufactured according to EN 60.669-1

Flush mounting in universal box according EN-60.670 standard

Screw terminals (accepts from 1 mm<sup>2</sup> to 2.5 mm<sup>2</sup> cross section cable)

**2.- Material characteristics**

Main body: Polycarbonate

Glow wire test: 850 °C

Terminals: Brass CuZn33

Screws: Steel CQ15. Slotted Phillips pan head. Metric thread M3.5

External cover: ASA PC

**3.- Certifications**

CE certificate

**Product dimensions (mm)**

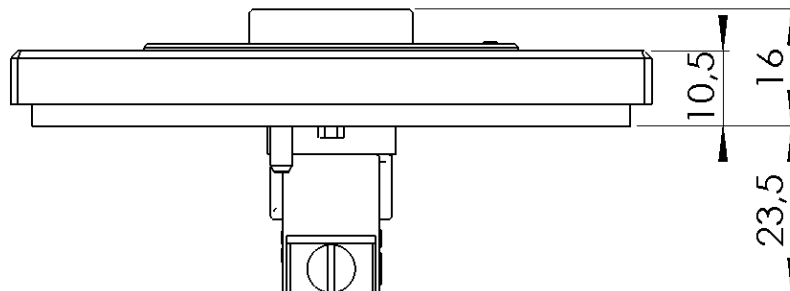

## Installation diagram

